



## Company

At Star 8 we commit ourselves to R&D, manufacture and technical innovation on PV modules and solar power system. To provide high quality products with various specifications for customers is always our pursuit.

## Characteristics

- High efficiency solar cell to keep the modules efficiency reach to 15.5%.
- Positive tolerance to ensure higher output.
- Excellent performance under weak light conditions.
- Modules withstand extremely (temperature, load and impact) TUV certification.
- All modules combination and packing through stepping current to keep effectively reduce mismatch loss within.
- 100% EL test to keep higher quality.



Anodized aluminum frame withstand corrosion and damage, Special osculum can reduce destruction by water freeze.

## Warranty

- 25 years power output warranty, 90% power output for 10years, and 80% power output for 25years.
- 5 years workmanship warranty.



IP65 junction box long-term weather endurance.

## Quality and safety

- ISO9001:2008 certified supplier, we provide world first class solar products for clients.
- IEC 61215, IEC 61730, IEC, CQC, CGC, CE, approved.





## Electrical Characteristics

Model No.	SW240P	SW245P	SW250P
Maximum Power (Pmax)	240W	245W	250W
Max-power Voltage (Vmp)	30.6V	30.9V	31.2V
Max-power Current (Imp)	7.84A	7.93A	8.01A
Open-circuit Voltage (Voc)	37.2V	37.3V	37.6V
Short-circuit Current (Isc)	8.37A	8.44A	8.53A
Module Efficiency	14.9%	15.2%	15.5%
Operating Temperature	-40°C ~ +85°C		
Maximum System Voltage	1000Vdc		
Maximum Series Fuse Rating	16A		
Power tolerance	0~+5W		

\*STC condition: 1000 W/m<sup>2</sup>, 1.5AM and 25°C cell temperature.

## Temperature characteristics

NOCT	46°C ± 2°C
Temperature Co-efficient of Pmax	-0.398%/°C
Temperature Co-efficient of Voc	-0.34%/°C
Temperature Co-efficient of Isc	-0.0576%/°C

## Mechanical characteristics

Model No.	SW240P/245P/250P
Cell Type	Polycrystalline silicon 156*156mm
Cell Arrangement	60(6*10)
Dimensions	1640*982*40mm
Weight	19.4Kg
Front Cover	3.2mm tempered glass
Frame Material	Anodized aluminium alloy
Junction Box	IP65 rated
Output Cables	4mm <sup>2</sup> , Length 1000mm
Connectors	MC4 comparable

## Packing

Packing	20'GP	40'GP
Pieces per Carton	22	22
Carton/Pallet	1	1
Pallet/Container	12	28
Pieces/container	264	616

## I-V Curve

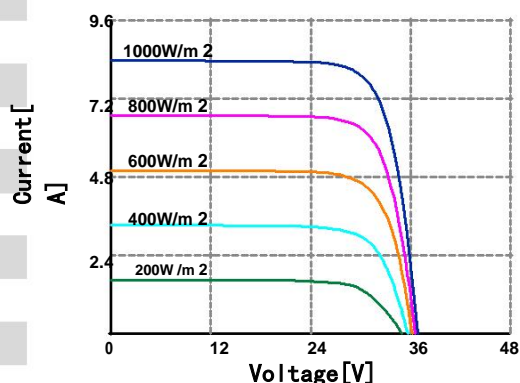

## Dimensions

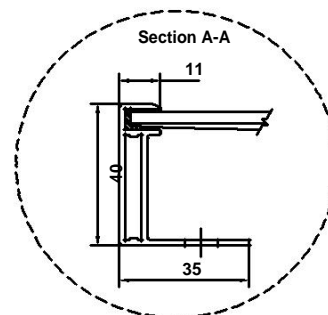
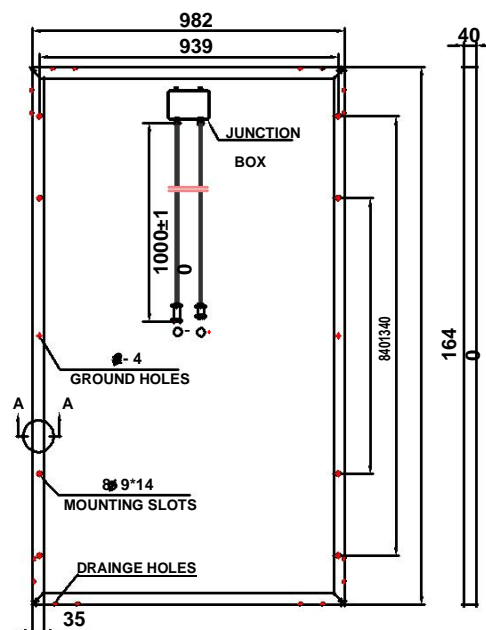

# POLYCRYSTALLINE SOLAR MODULES

Star8 (Thailand) Co.,Ltd.  
252 Krung hon Muang Kaew Building,  
Sirinthorn Road, Bangplad, Bangkok 10700 Thailand.

www.star8thailand.com Tel: 0922502424 email: sales@star8thailand.com Website: www.star8thailand.com *Your endless energy*